

# McKissick® Sheaves

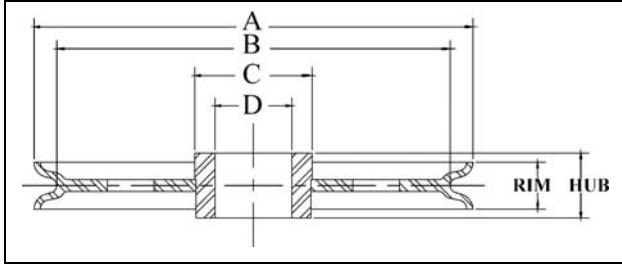

**SEE APPLICATION AND WARNING INFORMATION**

Para Español: [www.thecrosbygroup.com](http://www.thecrosbygroup.com)

See Pages 342-349

## Common Bore Sheaves

- Roll Forged™ sheaves are available in sizes up to 1829mm in diameter.
- Common Bore or Plain Bore are terms used when there is merely a hole bored in the center of the sheave.
- Common Bore Sheaves are machined for a running fit for the shaft size listed.

"A" Nominal Outside Diameter (mm)*	Stock No.	Pattern Number	Wire Line Size (mm)	"D" Bore Size (mm)	Hub Width (mm)	Rim Width (mm)	"C" Nominal Hub Outside Dia. (mm)	"B" Nominal Tread Dia. (mm)	Material	Approx. Weight (kg)
76.0	905051	1161	5	9.55	19.8	19.1	25.4	60.5	P.M.	0.45
76.0	905079	1161	5	12.7	19.8	19.1	25.4	60.5	P.M.	0.45
76.0	905097	1161	5	15.9	19.8	19.1	25.4	60.5	P.M.	0.45
76.0	905024	1161	6	9.55	12.7	12.7	25.4	66.5	P.M.	0.34
76.0	905042	1161	6	12.7	12.7	12.7	25.4	66.5	P.M.	0.34
76.0	15410	1161	10	9.55	19.8	19.1	25.4	60.5	P.M.	0.45
76.0	905088	1161	10	12.7	19.8	19.1	25.4	60.5	P.M.	0.45
76.0	905104	1161	10	15.9	19.8	19.1	25.4	60.5	P.M.	0.27
-	-	-	-	-	-	-	-	-	-	-
102	905113	1161	5	12.7	19.1	15.9	34.9	89.0	P.M.	0.45
102	905131	1161	5	15.9	19.1	15.9	34.9	89.0	P.M.	0.45
102	905122	1161	8	12.7	19.1	15.9	34.9	89.0	P.M.	0.45
102	905140	1161	8	15.9	19.1	15.9	34.9	89.0	P.M.	0.45
102	905168	1161	10	12.7	20.6	19.1	38.1	82.5	P.M.	0.57
102	905186	1161	10	15.9	20.6	19.1	38.1	82.5	P.M.	0.57
102	905202	1161	10	19.1	20.6	19.1	38.1	82.5	P.M.	0.57
102	905220	1161	13	12.7	27.0	25.4	41.3	81.0	P.M.	0.68
102	905248	1161	13	15.9	27.0	25.4	41.3	81.0	P.M.	0.68
102	905266	1161	13	19.1	27.0	25.4	41.3	81.0	P.M.	0.68
-	-	-	-	-	-	-	-	-	-	-
127	905275	1161	5	15.9	23.8	22.2	57.0	108	P.M.	1.02
127	905293	1161	5	19.1	23.8	22.2	57.0	108	P.M.	1.02
127	905284	1161	10	15.9	23.8	22.2	57.0	108	P.M.	1.25
127	905300	1161	10	19.1	23.8	22.2	57.0	108	P.M.	1.02
127	905328	1161	13	15.9	27.0	25.4	57.0	102	P.M.	1.13
127	905364	1161	13	15.9	30.2	28.6	57.0	102	D.I.	1.81
127	905346	1161	13	19.1	27.0	25.4	57.0	102	P.M.	1.13
127	905382	1161	13	19.1	30.2	28.6	57.0	102	D.I.	1.81
127	905408	1161	13	22.2	30.2	28.6	57.0	102	D.I.	1.81
-	-	-	-	-	-	-	-	-	-	-
152	905426	1161	10	12.7	20.6	19.1	47.6	127	D.I.	1.13
152	905480	1161	10	12.7	27.0	25.4	47.6	127	D.I.	1.13
152	905462	1161	10	15.9	20.6	19.1	47.6	127	P.M.	1.13
152	905523	1161	10	19.1	27.0	25.4	47.6	127	P.M.	1.89
152	909020	1181	13	22.2	27.0	25.4	47.6	124	P.M.	1.70
152	909066	1181	16	19.1	33.3	31.8	47.6	121	P.M.	1.70
152	909084	1181	16	22.2	33.3	31.8	47.6	121	P.M.	1.70
152	909100	1181	16	25.4	33.3	31.8	47.6	121	P.M.	1.70
152	909164	1181	19	25.4	39.7	38.1	76.2	117	P.M.	3.06
-	-	-	-	-	-	-	-	-	-	-
171	905694	1161	6	19.1	30.2	28.6	51.0	149	D.I.	2.27
171	905710	1161	6	25.4	30.2	28.6	51.0	149	D.I.	2.27
171	905701	1161	10	19.1	30.2	28.6	51.0	149	D.I.	2.27
171	905729	1161	10	25.4	30.2	28.6	51.0	149	D.I.	2.27
-	-	-	-	-	-	-	-	-	-	-
203	905747	1161	13	19.1	28.6	25.4	60.5	175	D.I.	2.27
203	905765	1161	13	22.2	28.6	25.4	60.5	175	D.I.	2.27
203	905783	1161	13	25.4	28.6	25.4	60.5	175	D.I.	3.86
203	905809	1161	16	19.1	34.9	31.8	51.0	165	D.I.	2.72
203	905827	1161	16	22.2	34.9	31.8	51.0	165	D.I.	3.06
203	909306	1181	16	22.2	34.9	31.8	63.5	168	D.I.	3.86